



Electric Pressure Regulating Ball Valves for TeeJet Controls

- Designed to produce linear flow regulation and shutoff control in ag applications.
- Two wire lead provides easy installation
- Low power consumption, less than 1 amp

Part No.	Description
35-02090	Valve, 1 1/2" NPT 346 BR Poly Ball 6 Sec, TeeJet Connector
35-02099	Valve, 1" NPT 344 BRL Linear Poly Ball, 6 Sec, TeeJet Connector
35-02116	Valve, 3/4" NPT 334 BRL Linear Poly Ball
35-02083	Valve, 1" NPT 344BR Poly Ball, Nylon Body, 3 Sec
35-02084	Valve, 1 1/2" NPT 346BR Poly Ball, Poly Body, 3 Sec replaces valve with Part No. 879-0072

Mid-Tech Regulating Valve



801 Flow Meter



26mm Flow Meter

Flow Meters for TeeJet & Mid-Tech

A range of flow meters are available to match your application. Flow rates from 0.8 gpm to 400 gpm in a range of styles. If you do not see the flow meter you need listed, please call our NCI Parts Department and we will gladly assist you.

90-02176	Kit, 1" 801 Flow Meter w/ 1" Straight Hose Barb, 45-05315 adapter cable (Cable in for Mid-Tech; remove for TeeJet)
120-0151	1 1/2" Std Flow Meter, 1 1/2" Hose Barb, 9-185 gpm; *Requires one of two cables listed below
405-0044	*Cable, Flow Meter Interface, 12 ft
405-0056	*Cable, Flow Meter Interface, 24 ft
90-02315	Kit, 26 mm Flow Meter - 0.5m Cable, Deutsch Connector w/ 1 1/2" Hose Barb (MidTech w/ 45-05315 Cable)
90-02315	Kit, 26 mm Flow Meter - 0.5m Cable, Deutsch Connector w/ 1 1/2" Hose Barb (TeeJet)

744A Ball Valve Kit w/ High Capacity Regulator Valve

Includes:

- Higher flow capacity regulating valve
- Ball valve harness that mates to shut-off ball valve manifolds
- PSI Gauge

Does not include:

- Boom Shut Off Valve



344 Valve

			Kit Part Number	Part Number	Description	Qty																														
<table><tr><th>Model Number</th><th>Max Pressure</th><th>Flow Rate at a 5 PSI Pressure Drop</th></tr><tr><td>344BR-2</td><td>300 PSI</td><td>32 GPM</td></tr><tr><td>344BR-3</td><td>300 PSI</td><td>24 GPM</td></tr><tr><td>344BRL-2</td><td>300 PSI</td><td>27 GPM</td></tr><tr><td>* 344BPR-2</td><td>300 PSI</td><td>12 GPM</td></tr><tr><td>* 344BPR-3</td><td>300 PSI</td><td>12 GPM</td></tr><tr><td>346BR-2</td><td>150 PSI</td><td>100 GPM</td></tr><tr><td>346BR-3</td><td>150 PSI</td><td>64 GPM</td></tr><tr><td>* 346BPR-2</td><td>150 PSI</td><td>53 GPM</td></tr><tr><td>* 346BPR-3</td><td>150 PSI</td><td>53 GPM</td></tr></table>			Model Number	Max Pressure	Flow Rate at a 5 PSI Pressure Drop	344BR-2	300 PSI	32 GPM	344BR-3	300 PSI	24 GPM	344BRL-2	300 PSI	27 GPM	* 344BPR-2	300 PSI	12 GPM	* 344BPR-3	300 PSI	12 GPM	346BR-2	150 PSI	100 GPM	346BR-3	150 PSI	64 GPM	* 346BPR-2	150 PSI	53 GPM	* 346BPR-3	150 PSI	53 GPM	90-02579	98-70025	Manual, Maintenance Instruction, MI 744A	1
			Model Number	Max Pressure	Flow Rate at a 5 PSI Pressure Drop																															
			344BR-2	300 PSI	32 GPM																															
			344BR-3	300 PSI	24 GPM																															
			344BRL-2	300 PSI	27 GPM																															
			* 344BPR-2	300 PSI	12 GPM																															
			* 344BPR-3	300 PSI	12 GPM																															
			346BR-2	150 PSI	100 GPM																															
			346BR-3	150 PSI	64 GPM																															
			* 346BPR-2	150 PSI	53 GPM																															
			* 346BPR-3	150 PSI	53 GPM																															
35-02087	344BRL Valve, 3/4" Ball Linear, Reg w/ 1" Fittings, 18 Sec/ 27 GPM	1																																		
45-05385	Cable, Power Fused, 744	1																																		
45-10072	Harness, 744 Console, 12 ft, Miller	1																																		
45-10080	Harness, 744 Ball Valve	1																																		
64-50023	Bracket Mounting, CP36990-NYB	1																																		
67-20004	Fitting, Tee w/ Gauge, CP21476-NYB	1																																		
67-20005	Nipple, 3/4" Close Nylon, CP21737-NYB	1																																		
75-50035	Housing, Control 300L-3, 37203-300L-3 (300 PSI Gauge)	1																																		
80-01017	Box, 14" x 10" x 8"	1																																		
84-01017	Label, Console/Flag	1																																		
90-50141	Kit, Accessory Bag, 37225-COMMAT	1																																		
98-70025	Manual, Maintenance Instruction, MI 744A	1																																		

430 Ball Valve Series - On/Off Valves NEW

- Choose 2-way, 3-way, or flow back functionality with a wide range of boom section counts. Many inlet, outlet, and electrical connection options
- Install more valves in existing space and increase control capability - up to 15 booms
- Automatic Boom Section Control compatible
- The flow rate is 9.2 GPM at a 5 PSI pressure drop, 13.7 GPM at a 10 PSI pressure drop

430EC Series
2 Way



430EC Series
Flowback



Features	430 2-Way Ball Valve	430 Flow Back Ball Valve
Reliable on/off control	✓	✓
Instant shut-off at spray tips		✓
Special feature	Std on/off control	Boom side of valve; solution returned to tank
Quick response, low amperage	✓	✓
Extensive rate controller compatibility	✓	✓
Automatic boom section control compatibility	✓	✓
Applications	Simple, small- and medium-size sprayers	Wide range of sprayers with moderate per section flow requirements

Kit Part Number	Part Number	Description	Qty
MD-584302433EC2	433EC-2-D	430 Series 3 Valve Manifold; SPST Switch w/ 22 RPM & 0.6 Sec Shutoff Valve; 2 Way Valve; Lg Quick Connect Inlet; Positively Switched w/ DIN Connector	1
	58480EC-05-VX	Mini DIN Cables	3
	58456-1	Large Quick Connect x 1" NPT F Kit	1
	58456-1/4	Large Quick Connect Gauge PT NPT Kit	3
	45529-90-3/4	3/4 x 90 Hose Barb Outlet	4
MD-585708433EC3FB	433EC-3FB-D	430 Series 3 Valve Manifold, SPST Switch w/ 22 RPM & 0.6 Sec Shutoff Valve; 2 Way Flow Back; Lg Quick Connect Inlet; Positively Switched w/ DIN Connector	1
	58480EC-05-VX	Mini DIN Cables	3
	58456-1	Large Quick Connect x 1" NPT F Kit	1
	58456-1/4	Large Quick Connect Gauge PT NPT Kit	3
	45529-90-3/4	3/4 x 90 Hose Barb Outlet	4
	45529-P	Quick Connect Plug for Flow Back Port	1

450 Series Flow Back Manifold

- Flowback valves allow pressure from the boom lines to be relieved back to the tank when valve is switch off
- 22 RPM, 0.7 second shutoff fully open to close
- Flow rate is 32 GPM with 5 PSI pressure per valve, 45 GPM with 10 PSI pressure drop



450 Series
Front View



450 Series
Back View

Part Number	Description	Qty
SS-453BEC3FBFCVX	450 Flowback 3 Valve Manifold; SPST Switch w/ 22 RPM & 0.7 Sec Shutoff Valve; 50 Series Flange; Poly Ball; Positively Switched w/ 0.5M Connector, VX Connector Code	1
MD-9002579	Manual Spray Control (replaces MD-9050237)	1
TP-M200PLG075	2" Standard Port Prt Flg Plug w/ 3/5" FPT	1
TP-M200PLG025	2" Standard Port Flange w/ 1/4" FPT	1
TP-M100075BRB9000	Flanged x Hose Barb	3
SS-455299034	3/4" x 90 HB Outlet	1
SS-B45529P	Quick Connect Plug	1



TeeJet® DirectoValve®

2-Way Electrically Operated Solenoid Valves

AA144P-, AA144A-, AA145H-, DirectoValve Control Valves

- Stainless steel wetted parts provide additional corrosion resistance.
- Direct acting; large internal flow chamber without pilot hole reduces chance of clogging.

- Operate on 12 VDC system.
- Maximum pressure of 100 PSI.
- Encapsulated solenoid coil can be changed without removing valve from system.
- EPDM diaphragms and seat washers, Viton® optional.

- Continuous flow through bypass connection, with flow to spray line controlled by valve "on-off" action.



AA144P

AA144P-3
(Three Unit)

AA144P DirectoValve Control Valves

- 10 GPM (37.9 l/min) flow with only 5 PSI pressure drop.
- 2.5 amp current draw.
- Polypropylene body for chemical resistance.
- Fabric reinforced Viton diaphragms and seat washers.
- No stroke adjustment required.

- Corrosion resistant, 430SS solenoid grade armature and armature stop.
- Encapsulated coil and magnetic circuit.

How to order:

To order, specify AA144P- then "1", "2" or "3" to indicate number of units.

Example: AA144P-3

Model Number	Inlet Size	Outlet Size	Current Draw
AA144P-*	3/4"	1/2"	2.5 amp

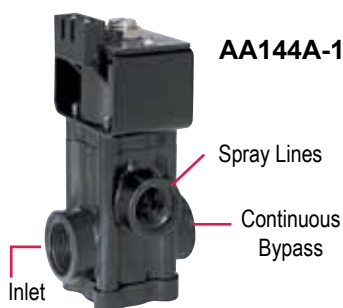

AA144A-1

AA144A Valve for Pressures up to 100 PSI

- 10 GPM flow with only 5 PSI pressure drop.
- Can be ganged with other 144A DirectoValve control valves.
- 2.5 amp current draw.
- Polypropylene body for chemical resistance.
- Fabric reinforced diaphragms.
- Also available as 2- or 3-unit assembly.

How to order:

To order, specify AA144A- then "1", "2" or "3" to indicate number of units.

Example: AA144A-3

AA144A-3
(Three Unit)

How to order:

Model Number	Inlet Size	Outlet Size	Current Draw
AA144A-*	3/4"	1/2"	2.5 amp



AA145H

AA145H Control Valves

- For pressures to 100 PSI; 15 GPM flow with 5 PSI pressure drop.
- Can be ganged with other 145H DirectoValve control valves.
- 2.9 amp current draw.
- Fiberglass reinforced Nylon body.

How to order:

Specify part number.

Example: AA145H-1

Model Number	Inlet Size	Outlet Size	Current Draw
AA145H-1	1"	1"	2.9 amp



Features:

- Polypropylene construction.
- Full port design.
- Viton® O-ring seal available with clamp (not included with flange).

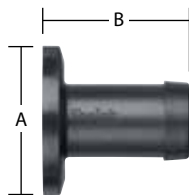

Straight Hose Barb Flanges

Description	Series	"A"	"B"	Part Number
3/4" Hose Barb	50	2" (51 mm)	11 1/16" (43 mm)	CP48150-PP
1" Hose Barb	50	2" (51 mm)	2" (51 mm)	CP45504-PP
1-1/4" Hose Barb	50	2" (51 mm)	2" (51 mm)	CP45505-PP
1-1/2" Hose Barb	50	2" (51 mm)	2" (51 mm)	CP45506-PP
1-1/4" Hose Barb	75	3-1/16" (78 mm)	1-13/16" (46 mm)	CP48160-PP
1-1/2" Hose Barb	75	3-1/16" (78 mm)	2-3/16" (56 mm)	CP46067-PP
2" Hose Barb	75	3-1/16" (78 mm)	2-3/4" (70 mm)	CP48161-PP

- Maximum pressure rating of 200 PSI for 75 series fittings.
- Maximum pressure rating of 300 PSI for 50 series fittings.

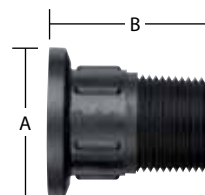

Threaded Flanges (Male)

Description	Series	"A"	"B"	Part Number
3/4" Male Pipe Thread	50	2" (51 mm)	2" (51 mm)	CP48172-PP
1" Male Pipe Thread	50	2" (51 mm)	2-3/16" (56 mm)	CP48155-PP
1-1/2" Male Pipe Thread	50	2" (51 mm)	2-3/4" (70 mm)	CP48156-PP
1-1/4" Male Pipe Thread	75	3-1/16" (78 mm)	2-1/2" (64 mm)	CP48165-PP
1-1/2" Male Pipe Thread	75	3-1/16" (78 mm)	2-1/2" (64 mm)	CP48166-PP
2" Male Pipe Thread	75	3-1/16" (78 mm)	2-9/16" (65 mm)	CP48167-PP



90° Hose Barb Flanges

Description	Series	"A"	"B"	"C"	Part Number
90° × 3/4" Hose Barb	50	2" (51 mm)	1-1/2" (38 mm)	2" (51 mm)	CP48151-PP
90° × 1" Hose Barb	50	2" (51 mm)	1-1/2" (38 mm)	2" (51 mm)	CP48152-PP
90° × 1-1/4" Hose Barb	50	2" (51 mm)	1-15/16" (49 mm)	2-9/16" (65 mm)	CP72238-PP
90° × 1-1/2" Hose Barb	50	2" (51 mm)	1-15/16" (49 mm)	2-9/16" (65 mm)	CP72239-PP
90° × 1-1/4" Hose Barb	75	3-1/16" (78 mm)	1-15/16" (49 mm)	2-9/16" (65 mm)	CP48162-PP
90° × 1-1/2" Hose Barb	75	3-1/16" (78 mm)	1-15/16" (49 mm)	2-9/16" (65 mm)	CP48163-PP
90° × 2" Hose Barb	75	3-1/16" (78 mm)	1-15/16" (49 mm)	3-5/16" (84 mm)	CP48164-PP

Gauge Port Flange

Description	Series	"A"	"B"	Part Number
1/4" Gauge Port	50	2" (51 mm)	3/4" (19 mm)	CP45508-1/4-PP CP(P)45508-1/4-PP
3/8" Gauge Port	50	2" (51 mm)	3/4" (19 mm)	CP45539-3/8-PP CP(P)45539-3/8-PP
Blank Inlet Cover	50	2" (51 mm)	5/16" (8 mm)	CP45507-PP
1/4" Gauge Port	75	3-1/16" (78 mm)	3/8" (9 mm)	CP46127-1/4-PP
3/8" Gauge Port	75	3-1/16" (78 mm)	3/8" (9 mm)	CP46127-3/8-PP
Blank Inlet Cover	75	3-1/16" (78 mm)	3/8" (9 mm)	CP46069-PP

(P)=BSPP

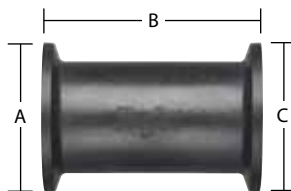
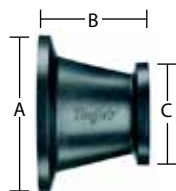

Straight Flange Couplings

Description	Series	"A"	"B"	"C"	Part Number
Straight Coupling	50	2" (51 mm)	2-1/4" (57 mm)	2" (51 mm)	CP48157-PP
Straight Coupling	75	3-1/16" (78 mm)	4-3/8" (111 mm)	3-1/16" (78 mm)	CP48169-PP
Reducer Coupling	75/50	3-1/16" (78 mm)	2-3/16" (56 mm)	2" (51 mm)	CP45207-PP

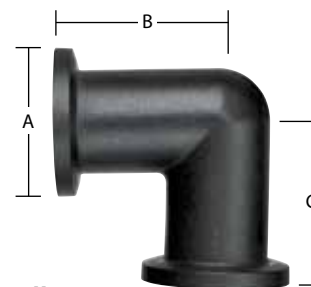

90° Flange Couplings

Description	Series	"A"	"B"	"C"	Part Number
90° Elbow Coupling	50	2" (51 mm)	2-3/16" (56 mm)	2-3/16" (56 mm)	CP48158-PP
90° Elbow Coupling	75	3-1/16" (78 mm)	2-3/16" (56 mm)	3-1/8" (79 mm)	CP48168-PP



TeeJet® DirectoValve® Flange Fittings



Threaded Flanges (Female)

Description	Series	"A"	"B"	Part Number
1" Female Pipe Thread	50	2"	2"	CP48154-PP
1-1/4" Female Pipe Thread	50	2"	2"	CP45512-PP
1-1/2" Female Pipe Thread	75	3-1/16"	2"	CP46066-PP



Flange Clamps

Part Number	Series	Description
46070	50	2-Way Valve
46024	50	3-Way Valve
55245-50	50	2-Way Valve Stainless Steel
CP7717-2/222-VI	50	Viton® O-ring
55245-75	75	2-Way Valve Stainless Steel
CP7717-2-229-VI	75	Viton O-ring



55245-50



55245-75

Note: O-ring included.

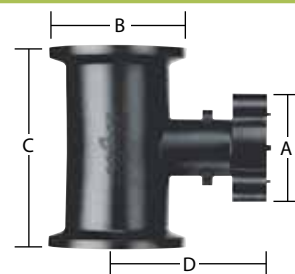
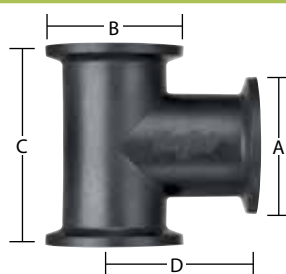

Tee Flanges

Description	Series	"A"	"B"	"C"	"D"	Part Number
Tee	50	2"	2"	4-3/8"	2-7/8"	CP50193-PP
Narrow Tee		2"	2"	3-3/16"	2"	CP55242-PP
Reducer Tee	50/75	2"	3-1/16"	4-3/8"	2-7/8"	CP46717-PP
Tee	75	3-1/16"	3-1/16"	4-3/8"	3-1/8"	CP46716-PP
450 Tee Body	75	-	3-1/16"	4-3/8"	3-1/4"	CP45251-PP
450 Tee Body (Narrow)	75	-	3-1/16"	3-1/8"	3-1/4"	CP55224-PP

Note: There are no mounting provisions on the 50 series tee.

48143 Mounting Kit

Mounts to underside of tee and includes one extrusion and four screws. Mounting kit is not included with tees. Must be ordered separately. Also requires 5/16" or 8 mm bolt.



Description	Part Number
Tee Mounting Kit (450 or 490 series manifold)	48143

DirectoValve® Quick Connect Fittings

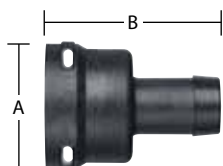

Quick Connect Straight Hose Barb

Description	Series	"A"	"B"	Part Number
1/2" Straight Hose Barb	QC	1-11/16"	2-1/4"	45529-1/2
3/4" Straight Hose Barb				45529-3/4
QC Straight Hose Barb				45529-1
Quick Connect Cap		1-11/16"	1-1/8"	45529-C
Quick Connect Plug		1-7/16"	1-5/16"	45529-P

Note: O-ring and clip included.

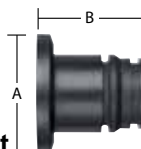

Quick Connection Outlet

Description	Series	"A"	"B"	Part Number
Male Quick Connect Flanged	50	2"	1-3/16"	CP46029-PP
Quick Connect	3/4" (M)	1-5/16"	2"	CP45527-NYB
Quick Connect	1" (M)	1-5/16"	2"	CP45526-NYB



90° Quick Connect Hose Barb

Description	Series	"A"	"B"	"C"	Part Number
1/2" 90° Hose Barb	QC	1-11/16"	2-19/64"	1-5/8"	45529-90-1/2
3/4" 90° Hose Barb					45529-90-3/4
1" 90° Hose Barb					45529-90-1

Note: O-ring and clip included.



Clip and O-Ring

Description	Part Number
Retaining Clip 302SS	CP37166-302SS
O-Ring (Viton®)	CP7717-3-912-VI

