

# Hydraulic Filter

## Oil Filter Replacement

For repair order Oil Filter Repair Kit # K-23001 containing 1 housing seal, 2 rubber seals, 1 element and 1 back-up washer.

### STEP 1:

Disassemble the filter

### STEP 2:

Discard the element, clean all remaining parts

### STEP 3:

Reassemble the housing center post, conical spring and one metal back-up washer.

Note—The conical spring is to be installed with the large end against the housing.

Lubricate the two (2) rubber seals (No. 3274, received with new element), Install one seal over the center post and against the back-up washer.

Place the element over the center post and engage the rubber seal into the recess in the element and cap.

Install the second seal into the recess at the top end of the element.

Lubricate seal (No. 1576) located on the filter head (No. 1560). Position housing assembly into place on filter head and tighten center post.

**CAUTION:** Keep housing from rotating while tightening center post to 20 ft.lbs. torque.

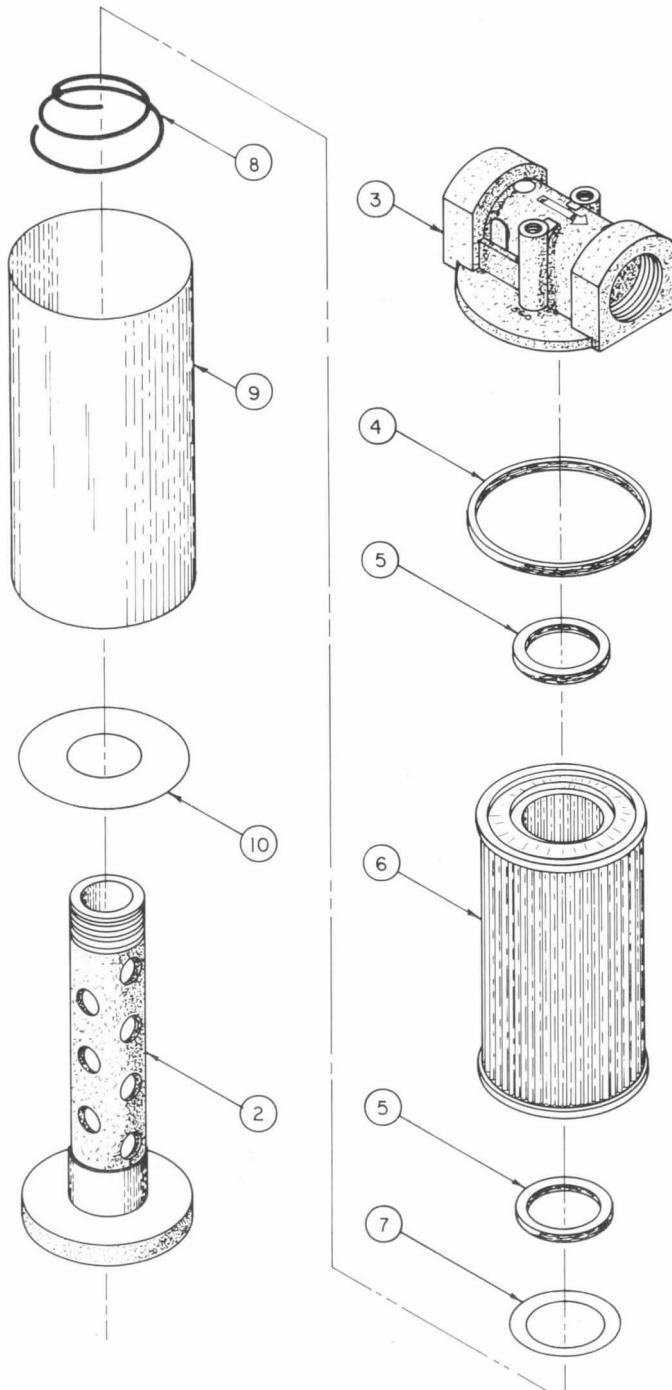

HYDRAULIC SYSTEM FILTER		
ITEM	DISCRIPTION	QUAN. FB-215
1	COMPOUND INDICATOR	1
2	CENTER POST	1
3	HEAD CASTING	1
4	HOUSING SEAL	1
5	RUBBER SEAL	2
6	ELEMENT	1
7	BACK-UP WASHER	1
8	CONICAL SPRING	1
9	FILTER HOUSING	1
10	CENTER POST SEAL	1

Note: This drawing is from  
NCI Operator's Manual  
for  
Dry Spreader Body  
June 1980